

# PULLEX Crocodile

## Bar puller integrated with the machine's part-off tool

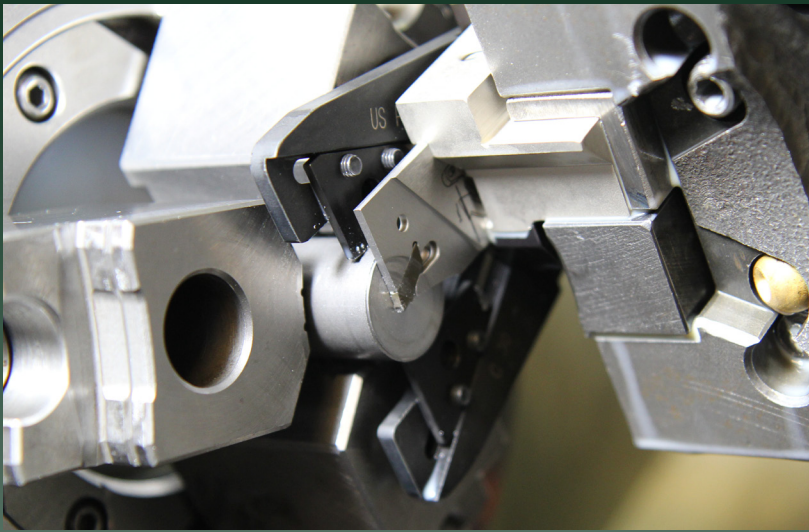

- Fitted together with the part-off tool
- Tremendously fast - it clamps the bar instantaneously after cut-off and spindle stop
- Flexible design - can be ordered as a ready-to-run unit with toolholder or to fit with an existing toolholder
- Compact design
  - Doesn't need it's own turret station
  - Very narrow - builds out very little
  - Clamps very close to the chuck jaws
- Easy to setup and use

You can't possibly get the work done faster than using this revolutionary Bar Puller.

Pullex feeds the bar within 1.5-2 seconds to be compared with the job of a conventional Shortbar Feeder, which would take 10-15 seconds to execute the same operation.

Then, assuming a machining cycle time of 50 seconds for your workpiece and you'll find that:

- you are going to save one day each week using Pullex
- this is a most profitable accessory for your CNC-lathe

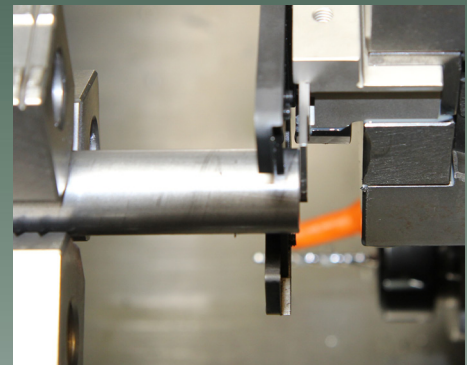

**Pullex Crocodile 0-30 mm**

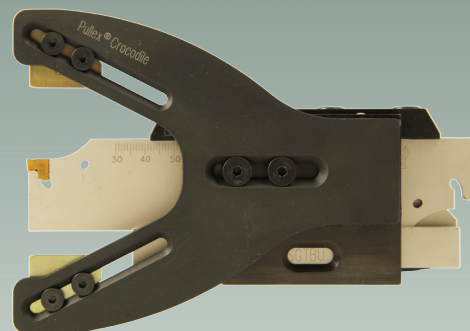

**Pullex Crocodile 30-60 mm**

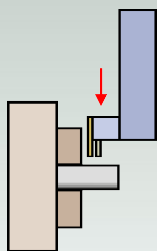

In position for cut-off

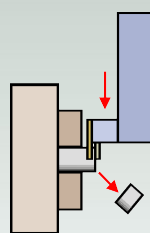

After cut-off, the Spindle is stopped

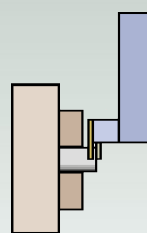

Pullex advances a little behind the bar centre for gripping the bar

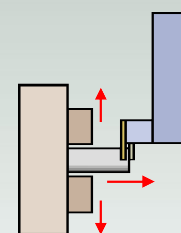

The chuck jaws are unclamped and the bar is pulled out into the new cutting position

## Complete with tool holder



C-Complete-30

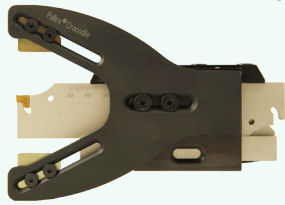

C-Complete-60

Order Code	Containing	Capacity
C-Complete-30	1 x Pullex Frame C30 1 x Fixing Plate C301-29.5 1 x Set of Pulling plates PFD-1 1 x Iscar Tool Holder SGTBU 20-5G 1 x Iscar Blade Tang-Grip TGFH 26-4 1 x Iscar Insert TAG N4C	1-30 mm
C-Complete-60	1 x Pullex Frame C60 1 x Fixing Plate C601-37 1 x Set of Pulling plates PFD-1 1 x Iscar Tool Holder SGTBU 32-25-6G 1 x Iscar Blade Tang-Grip TGFH-32-4 1 x Iscar Insert TAG N4C	30-60 mm
PFD-1	Pulling plates (2 pcs)	

## Own tool holder - Shank type



C30



C60



C302  
C602

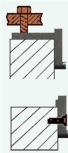

To be mounted on the part-off tool shank



C303  
C603



To be fitted by screws on the part-off tool shank

Order Code	Description	Capacity
C30	Frame	1-30 mm
C60	Frame	30-60 mm
C302	Fixing plate for C30	
C303	Fixing plate for C30	
C602	Fixing plate for C60 (also suitable for C30)	
C603	Fixing plate for C60 (also suitable for C30)	
PFD-1	Pulling plates (2 pcs)	

A typical Pullex Crocodile system consist of 1 x Frame  
1 x Fixing Plate  
1 x set of Pulling Plates

## Own tool holder - Blade type



C30



C60



C601



PFD-1

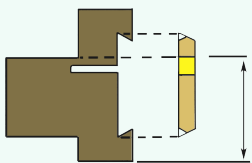

The A-measure is the distance between the upper side of the insert to the under side of the tool block

Order Code	Description	Capacity
C30	Frame	1-30 mm
C60	Frame	30-60 mm
C301-29.5	Fixing plate for C30 (A measure=29.5) Iscar type SGTBU-20-5G for blade 26/21,4 Iscar type SGTB-25.5G * Sandvik type 151.2-202021M for blade 25,9/21,4	
C601-33	Fixing plate for C60 (A measure=33) Iscar type SGTBU-20-6G for blade 32/24.4 Iscar type SGTBU-20C-6 Iscar type SGTBU-25-6G Iscar type SGTBU-25C-6	
C601-35	Fixing plate for C60 (A measure=35) * Sandvik type 151.2-2520-25 for blade 31,9/25	
C601-37	Fixing plate for C60 (A measure=37) Iscar type SGTBU-32-6G for blade 32/24,8 Iscar type SGTBU-32-25-6G * Sandvik type 151.2-3232-25 for blade 31.9/25	
PFD-1	Pulling plates (2 pcs)	

A typical Pullex Crocodile system consist of 1 x Frame  
1 x Fixing Plate  
1 x set of Pulling Plates

Distributed by:

**MPC**

MPC Automation Systems AB  
Box 5879, S-102 40 Stockholm, Sweden  
Phone: +46 8 6670950 Fax +46 8 6670952

Visit us at <http://www.barpuller.com>